

O-Ring Seal Fittings



O型圈面密封接头

- 特征:**
- ◇ 密封圈密封保证了从真空到高压的完美密封
 - ◇ 密封圈完全实现了最大效率
 - ◇ 与接管面光滑连接确保良好封装
 - ◇ 螺母端测试孔易于进行泄漏测试
 - ◇ 易于安装和维护
 - ◇ 内螺纹镀银处理
 - ◇ 尺寸范围: 1/8"至1"
 - ◇ 每个接管和本体都刻有尺寸、材料和炉号

技术数据:

◇ 螺纹标准

螺纹类型	标准
NPT螺纹	ASME B1.20.1, SAE AS71051
SAE/MS直螺纹	ASME B1.1, SAE J475

◇ 材料

材料	棒料	锻件
316SS	ASTM A479	ASTM A182
316L SS	SEMI F20	SEMI F20

◇ 焊接端管尺寸及壁厚

英制		公制	
Tube 管外径 in.	壁厚 in.	Tube 管外径 mm	壁厚 mm
1/8	0.028	6	1.0
1/4	0.035	8	1.0
3/8	0.035	10	1.0
1/2	0.049	12	1.0
3/4	0.049	18	1.5
1	0.065		
1 1/2	0.065		
2	0.065		

◇ 工作压力

样本所示工作压力是在室温下根据 ASME B31.3 和 B31.1 计算。

O-Ring Seal Fittings

◇ 工作温度

接头工作温度范围由 O 型圈材料决定

材料	代号	工作温度
氟橡胶 FKM (70 硬度)	FK	-23°C 至 204°C
氟橡胶 FFKM (90 硬度)	FF	-39°C 至 316°C

SAE/MS 端口默认使用的是氟橡胶FKM(90硬度)的O型圈

测试:

F0接头按照最大氦气泄漏率 4×10^{-9} std cm³/s 设计。

安装说明:

1. 按照左图所示，依次安装接管、螺母、O型圈和本体，并手紧螺母。
2. 将接头本体牢牢固定，用扳手拧螺母 1/8-1/4 圈，直到拧动力矩出现急剧升高为止。（见右图）

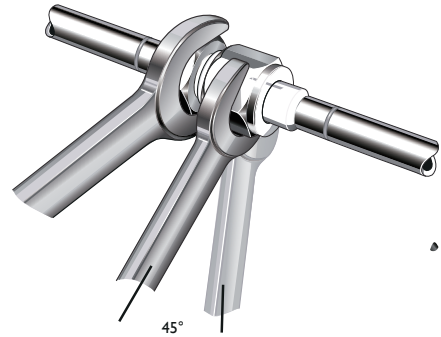
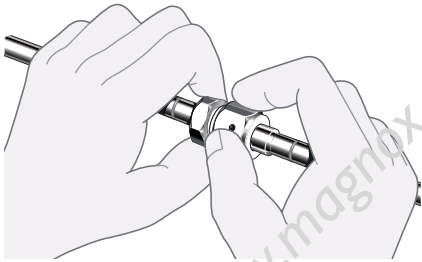

注意事项:

- ◇ 尺寸仅供参考，可能有变动
- ◇ 每次安装时都应检查O型圈是否完好，如有破损需更换O型圈
- ◇ 在焊接本体前，应当拆下O型圈以免被破坏
- ◇ 推荐使用钨极惰性气体保护焊
- ◇ 不要在系统有压力的时候松开和紧固接头

ORDERING INFORMATION

订购信息

40V		RBUT		F4	4	FK	FF4
材质		产品代码		尺寸1 FO面		尺寸2 终端尺寸	
40	SUS316L	RGTBW	Gland To Tunc Butt Weld (对焊接头)	F4	1/4"	4	1/4"
40V	SUS316L VAR	RGTSW	Gland To Socket Weld (承插焊接头)	F6	3/8"	6	3/8"
40W	SUS316L VIM+VAR	RGTSWR	Gland To Tube Socket Weld Reducing (变径承插焊接头)	F8	1/2"	8	1/2"
		RGTP	Gland To Tube Port (卡套管接头)	F12	3/4"	12	3/4"
		RGATW	Gland To Automatic Tube Weld (卡套管自动焊接头)	F16	1"	16	1"
		RWGMIN	Welded Gland To Male Npt (焊式Npt外牙接头)				
		RWGST	Welded Gland To Sae/ms Thread (焊式Sae/ms外牙接头)				
		RWGFN	Welded Gland To Female Npt (焊式Npt内牙接头)				
		RWGTf	Welded Gland To Tube Fitting (焊式卡套接头)				
		RWGU	Welded Gland Union (焊式直通接头) body Union Tee (本体三通接头)				
		RBUT	Body Union Tee (本体三通接头)				
		RBUB	Bulkhead Union Body (本体穿板直通接头)				
		RBST	Body To SAE/MS Thread (本体Sae/ms外牙接头)				
		RBFN	Body To Female Npt (本体Npt内牙接头)				
		RBTF	Body To Tube Fitting (本体卡套接头)				
		RBBTF	Body To Bulkhead Tube Fitting (本体穿板卡套接头)				
		RUB	Union Body (本体直通接头)				
		RBMN	Body To Male Npt (本体Npt外牙接头)				
		RBTsw	Body To Tube Socket Weld (本体承插焊接头)				
		RBUE	Body Union Elbow (本体 90°弯头)				
		RBATW	Body To Automatic Tube Weld (本体自动焊接头)				
		RBME	Body To Male Npt Elbow (本体Npt外牙弯头)				
		RBTfE	Body To Tube Fitting Elbow (本体卡套弯头)				
		RBME	Body To Male Sae/ms Thread Adjustable Elbow (本体Sae/ms弯头)				
		RFN	Female Nut (内牙螺帽)				
		RMN	Male Nut (外牙螺帽)				
		RRO	O-ring (密封圈)				
		RBMN	Blind Male Nut (盲孔外牙堵头)				
		RBFN	Blind Body (盲孔内牙堵头)				

密封圈		品表面处理	
FK	FKM 氟橡胶密封圈	BLANK	BA Ra ≤ 0.8μm
FF	FFKM 全氟醚密封	F4	EP Ra ≤ 0.375μm

说明:

型号说明仅用于说明型号组成规则, 有些组合实际并不存在; 如有疑问请联系迈格诺科相关销售工程师

O-Ring Seal Fittings

Butt Welding Joint 对焊接头

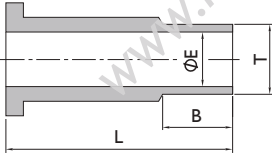

Gland to Tube Butt Weld					
FO Size (in.)	T-Tube O.D. (in.)	Ordering Number	Dimension, mm		
			L	B	E
1/4	1/8	RGTBW-F4-T2	19.6	7.1	1.5
1/4	1/4	RGTBW-F4-T4	28.4	10.4	3.0
1/2	1/4	RGTBW-F8-T4	23.1	10.4	3.0
1/2	3/8	RGTBW-F8-T6	21.3	10.4	5.8
1/2	1/2	RGTBW-F8-T8	26.5	12.7	8.4

Socket Welded Joint 承插焊接头

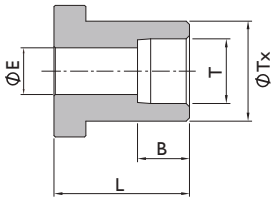

Gland to Tube Socket Weld						
FO Size (in.)	T-Tube O.D. (in.)	Ordering Number	Dimension, mm			
			L	B	E	Tx
1/8	1/8	RGTSW-F2-T2	19.6	2.5	2.3	9.7
1/4	1/4	RGTSW-F4-T4	19.6	7.1	4.6	9.7
3/8	3/8	RGTSW-F6-T6	20.6	7.9	7.1	15.2
1/2	1/2	RGTSW-F8-T8	20.6	9.7	10.2	15.2
3/4	3/4	RGTSW-F12-T12	23.9	12.2	15.7	23.4
1	1	RGTSW-F16-T16	24.9	15.7	22.1	30.2

Variable Diameter Socket Welding Joint 变径承插焊接头

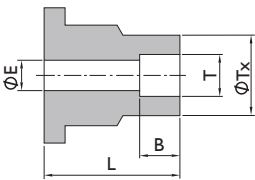

Gland to Tube Socket Weld Reducing						
FO Size (in.)	T-Tube O.D. (in.)	Ordering Number	Dimension, mm			
			L	B	E	Tx
1/4	1/8	RGTSWR-F4-T2	19.6	2.5	2.3	7.4
1/2	1/4	RGTSWR-F8-T4	20.6	7.1	4.6	12.2

Tube Fittings 变径承插焊接头

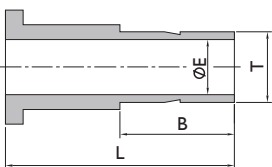

Gland to Tube Port					
FO Size (in.)	T-Tube O.D. (in.)	Ordering Number	Dimension, mm		
			L	B	E
1/4	1/4	RGTP-F4-T4	33.3	16.3	4.6
1/2	3/8	RGTP-F8-T6	35.1	17.8	6.8
1/2	1/2	RGTP-F8-T8	41.1	24.4	9.3
3/4	3/4	RGTP-F12-T12	45.7	25.9	14.7
1	1	RGTP-F16-T16	52.1	33.0	20.3

O-Ring Seal Fittings

Automatic Welding Head For Casing Pipe 卡套管自动焊接头

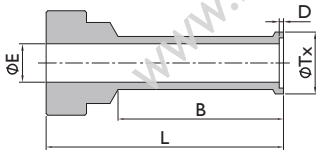

Gland to Automatic Tube Weld							
FO Size (in.)	T-Tube O.D. (in.)	Ordering Number	Dimension, mm				
			L	B	D	E	Tx
1/4	1/4	RGATW-F4-T4	28.4	19.8	0.51	4.6	7.4
1/2	3/8	RGATW-F8-T6	28.7	20.0	0.76	7.9	10.4
1/2	1/2	RGATW-F8-T8	29.0	20.3	1.0	10.2	14.0
3/4	3/4	RGATW-F12-T12	30.5	20.3	1.0	16.5	20.3
1	1	RGATW-F16-T16	35.8	25.4	1.0	22.1	26.9

Welded NPT External Tooth Joint 焊式NPT外牙接头

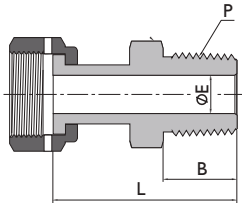

Welded Gland to Male NPT					
FO Size (in.)	P-NPT Size	Ordering Number	Dimension, mm		
			L	B	E
1/4	1/4	RWGMN-F4-4	40.4	14.2	4.6
1/2	3/8	RWGMN-F8-6	42.4	14.2	10.2
1/2	1/2	RWGMN-F8-8	47.5	19.1	10.2
3/4	3/4	RWGMN-F12-12	51.6	19.1	15.7
1	1	RWGMN-F16-16	59.9	23.9	22.1

Welded SAE External Tooth Joint 焊式SAE外牙接头

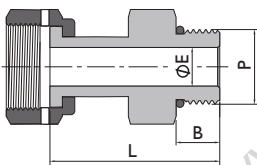

Welded Gland to SAE/MS Thread					
FO Size (in.)	P-SAE/MS Thread Size	Ordering Number	Dimension, mm		
			L	B	E
1/4	7/16-20	RWGST-F4-2	39.1	9.1	4.6
1/2	9/16-18	RWGST-F4-4	41.7	9.9	10.2
1/2	3/4-16	RWGST-F8-12	43.4	11.2	10.2
3/4	1 1/16-12	RWGST-F12-17	52.6	15.0	15.7
1	1 5/16-12	RWGST-F16-21	55.1	17.0	22.1

Welded NPT Internal Tooth Joint 焊式NPT内牙接头

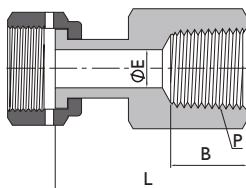

Welded Gland to Female NPT					
FO Size (in.)	P-NPT Size	Ordering Number	Dimension, mm		
			L	B	E
1/4	1/4	RWGFN-F4-4	39.9	15.0	4.6
1/2	3/8	RWGFN-F8-6	43.9	15.0	10.2
1/2	1/2	RWGFN-F8-8	49.8	19.8	10.2
3/4	3/4	RWGFN-F12-12	53.8	20.6	15.7
1	1	RWGFN-F16-16	58.2	25.4	22.1

O-Ring Seal Fittings

Welded Ferrule Joint 焊式卡套接头

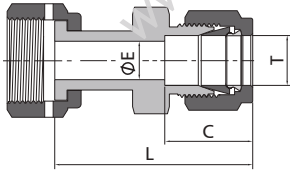

Welded Gland to Tube Fitting					
FO Size (in.)	T-Tube O.D. (in.)	Ordering Number	Dimension, mm		
			L	C	E
1/4	1/4	RWGTF-F4-4	44.2	15.2	4.6
1/2	3/8	RWGTF-F8-6	47.5	16.8	7.1
1/2	1/2	RWGTF-F8-8	51.1	22.9	10.2
3/4	3/4	RWGTF-F12-12	54.4	24.4	15.7
1	1	RWGTF-F16-16	62.2	31.2	22.1

Welded Straight Joint 焊式直通接头

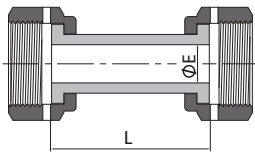

Welded Gland Union			
FO Size (in.)	Ordering Number	Dimension, mm	
		L	E
1/4	RWGU-F4	36.1	4.6
1/2	RWGU-F8	40.9	10.2

Body Tee Joint 本体三通接头

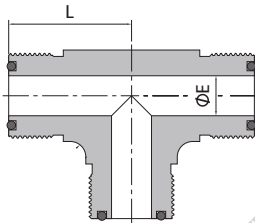

Welded Gland to Tube Fitting			
FO Size (in.)	Ordering Number	Dimension, mm	
		L	E
1/4	RBUT-F4	24.4	4.6
1/2	RBUT-F8	32.0	10.2
3/4	RBUT-F12	37.6	15.7
1	RBUT-F16	39.6	22.1

Body Straight Connector 本体直通接头

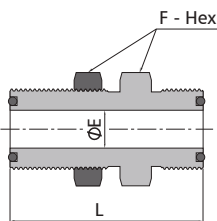

Welded Gland Union				
FO Size (in.)	Ordering Number	Dimension, mm		
		L	F	E
1/4	RBUB-F4	47.8	19.1	4.6
1/2	RBUB-F8	53.1	27.0	10.2

O-Ring Seal Fittings

Body SAE/MS External Tooth Joint 本体SAE/MS外牙接头

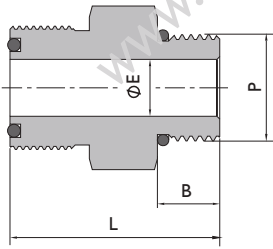

Body to SAE/MS Thread					
FO Size (in.)	P-SAE/MS Thread Size	Ordering Number	Dimension, mm		
			L	B	E
1/4	7/16-20	RBST-F4-7	31.5	9.1	4.6
1/4	9/16-18	RBST-F4-9	29.7	9.9	4.6
1/2	7/16-20	RBST-F8-7	34.5	9.1	4.6
1/2	9/16-18	RBST-F8-9	35.3	9.9	7.6
1/2	3/4-16	RBST-F8-12	37.3	11.2	10.2
3/4	1 1/16-12	RBST-F12-17	43.2	15.0	15.7
1	1 5/16-12	RBST-F16-21	45.5	15.0	21.6

Welded Ferrule Joint 本体NPT内牙接头

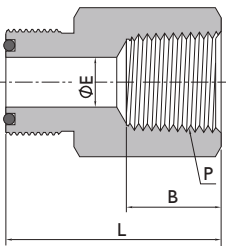

Body to Female NPT					
FO Size (in.)	P-NPT Size (in.)	Ordering Number	Dimension, mm		
			L	B	E
1/4	1/8	RBFN-F4-2	31.8	10.4	4.6
1/4	1/4	RBFN-F4-4	35.3	15.0	4.6
1/2	3/8	RBFN-F8-6	39.9	15.0	10.2
1/2	1/2	RBFN-F8-8	45.0	19.8	10.2
3/4	3/4	RBFN-F12-12	49.0	20.6	15.7
1	1	RBFN-F16-16	51.3	25.4	22.1

Body Ferrule Connector 本体卡套接头

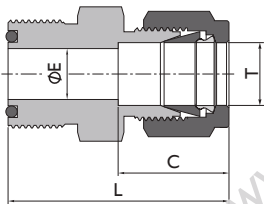

Body to Tube Fitting					
FO Size (in.)	T-tube O.D. (in.)	Ordering Number	Dimension, mm		
			L	C	E
1/4	1/8	RBTF-F4-2	35.1	13.0	2.3
1/4	1/4	RBTF-F4-4	37.3	15.2	4.6
1/2	3/8	RBTF-F8-6	41.9	16.8	7.1
1/2	1/2	RBTF-F8-8	45.2	22.9	10.2
3/4	3/4	RBTF-F12-12	47.2	24.4	15.7
1	1	RBTF-F16-16	52.3	31.2	22.1

Body Threading Card Sleeve Joint 本体穿板卡套接头

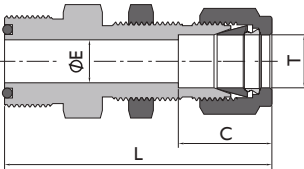

Body to Bulkhead Tube Fitting					
FO Size (in.)	T-tube O.D. (in.)	Ordering Number	Dimension, mm		
			L	C	E
1/4	1/4	RBBTF-F4-4	53.4	15.2	4.6
1/2	3/8	RBBTF-F8-6	59.4	16.8	7.1
1/2	1/2	RBBTF-F8-8	64.8	22.9	10.2
3/4	3/4	RBBTF-12-12	72.6	24.4	15.7
1	1	RBBTF-16-16	83.6	31.2	22.1

O-Ring Seal Fittings

Body Straight Connector 本体直通接头

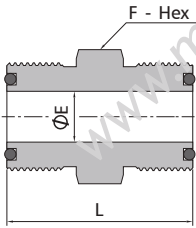

Union Body					
FO Size (in.)	FO Size (in.)	Ordering Number	Dimension, mm		
			L	F	E
1/4	1/4	RUB-F4-F4	31.8	15.9	4.6
1/2	1/4	RUB-F8-F4	36.3	23.8	4.6
1/2	1/2	RUB-F8-F8	38.1	23.8	0.2

Main Body NPT External Tooth Joint 本体NPT外牙接头

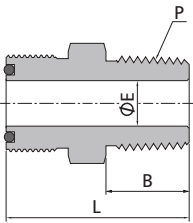

Body to Male NPT					
FO Size (in.)	P-NPT Size	Ordering Number	Dimension, mm		
			L	B	E
1/4	1/8	RBMN-F4-2	29.5	9.7	4.6
1/4	1/4	RBMN-F4-4	34.0	14.2	4.6
1/2	3/8	RBMN-F8-6	37.1	14.2	9.7
1/2	1/2	RBMN-F8-8	41.9	19.1	10.2
3/4	3/4	RBMN-F12-12	44.5	19.1	15.7
1	1	RBMN-F16-16	50.0	23.9	22.1

Body Socket Welding Joint 本体承插焊接头

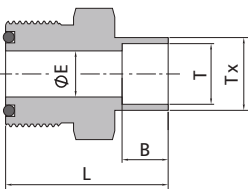

Body to Tube Socket Weld						
FO Size (in.)	T-Tube O.D. (in.)	Ordering Number	Dimension, mm			
			L	E	B	Tx
1/4	1/8	RBTSW-F4-2	22.4	2.3	2.5	7.4
1/4	1/4	RBTSW-F4-4	27.7	4.6	7.1	9.7
1/2	3/8	RBTSW-F8-6	32.5	7.1	7.9	15.2
1/2	1/2	RBTSW-F8-8	34.0	10.2	9.7	15.2
3/4	3/4	RBTSW-F12-12	38.1	15.7	11.2	23.4
1	1	RBTSW-F16-16	43.7	22.1	15.7	30.2

Body 90° Elbow 本体 90° 弯头

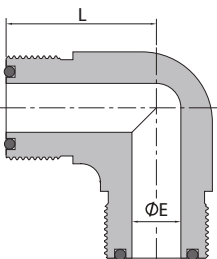

Body Union Elbow			
FO Size (in.)	Ordering Number	Dimension, mm	
		L	E
1/4	RBUE-F4	24.4	4.6
1/2	RBUE-F8	32.0	10.2
3/4	RBUE-F12	37.6	15.7
1	RBUE-F16	39.6	22.1

O-Ring Seal Fittings

Automatic Welding Head Of The Body 本体自动焊接头

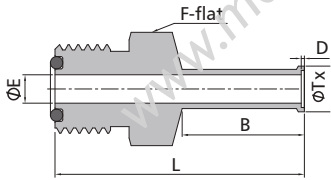

Body to Automatic Tube Weld							
FO Size (in.)	T-tube O.D. (in.)	Ordering Number	Dimension, mm				
			L	B	D	E	Tx
1/4	1/4	RBATW-F4-4	40.4	19.8	0.5	4.6	7.4
1/2	3/8	RBATW-F8-6	44.2	20.0	0.8	7.9	10.4
1/2	1/2	RBATW-F8-8	44.4	20.3	1.0	0.2	14.0
3/4	3/4	RBATW-F12-12	45.2	20.3	1.0	6.5	20.3
1	1	RBATW-F16-16	51.6	23.4	1.0	2.1	26.9

Automatic Welding Head Of The Body 本体NPT外牙弯头

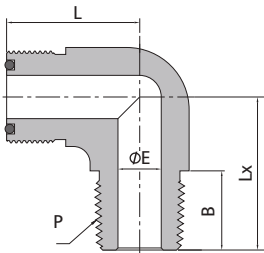

Body to Male NPT Elbow							
FO Size (in.)	P-NPT Size (in.)	Ordering Number	Dimension, mm				
			L	B	E	Lx	
1/4	1/8	RBMNE-F4-2	24.4	9.7	4.6	22.1	
1/4	1/4	RBMNE-F4-4	24.4	14.2	4.6	26.7	
1/2	3/8	RBMNE-F8-6	32.0	14.2	9.7	32.0	
1/2	1/2	RBMNE-F8-8	32.0	19.1	0.2	36.8	
3/4	3/4	RBMNE-F12-12	37.6	19.1	5.7	42.4	
1	1	RBMNE-F16-16	39.6	23.9	2.0	49.3	

Body Clamp Elbow 本体卡套弯头

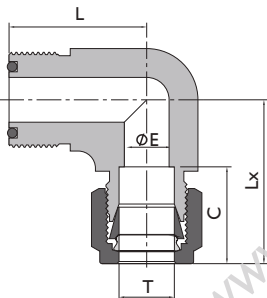

Body to Tube Fitting Elbow							
FO Size (in.)	T-Tube O.D. (in.)	Ordering Number	Dimension, mm				
			L	C	E	Lx	
1/4	1/4	RBTFB-F4-4	24.4	15.2	4.6	30.2	
1/2	3/8	RBTFB-F8-6	32.0	16.8	7.1	35.3	
1/2	1/2	RBTFB-F8-8	32.0	22.9	10.2	38.1	
3/4	3/4	RBTFB-F12-12	37.6	24.4	15.7	45.7	
1	1	RBTFB-F16-16	39.6	31.2	22.1	51.8	

Body Clamp Elbow 本体SAE/MS弯头

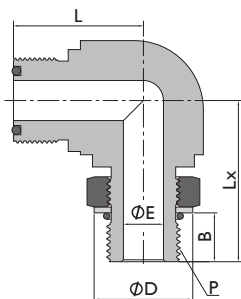

Body to Male SAE/MS Thread Adjustable Elbow							
FO Size (in.)	P-SAE/MS Thread Size (in.)	Ordering Number	Dimension, mm				
			L	B	E	D	Lx
1/4	7/16-20	RBMSE-F4-7	24.4	9.9	4.6	16.5	30.2
1/2	9/16-18	RBMSE-F8-9	33.8	11.2	7.6	20.1	39.1
1/2	3/4-16	RBMSE-F8-12	33.8	12.7	10.2	25.7	41.9
3/4	1 1/16-12	RBMSE-F12-17	38.9	16.8	15.7	36.6	54.1
1	1 5/16-12	RBMSE-F16-21	43.7	16.8	22.1	43.9	58.7

O-Ring Seal Fittings

Nuts 螺母

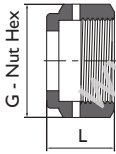

Female			
FO Size (in.)	Ordering Number	Dimension, mm	
		L	G
1/8-1/4	RFN-4	16.8	17.5
3/8-1/2	RFN-8	17.5	25.4
3/4	RFN-12	20.6	38.1
1	RFN-16	20.6	44.5

Blind Female Nut 堵帽

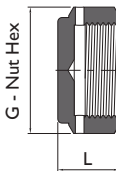

Blind Female Nut			
FO Size (in.)	Ordering Number	Dimension, mm	
		L	G
1/8-1/4	RBFN-4	11.2	17.5
3/8-1/2	RBFN-8	14.2	25.4
3/4	RBFN-12	19.1	38.1
1	RBFN-16	20.6	44.5

O-rings 密封圈

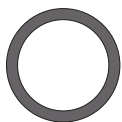

O-rings		
FO Size (in.)	Basic Ordering Number	
1/8-1/4	RO-4	
3/8-1/2	RO-8	
3/4	RO-12	
1	RO-16	

Blind Male Nut 堵塞

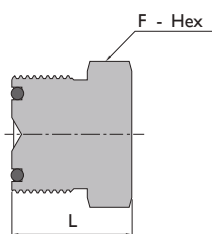

Blind Male Nut			
FO Size (in.)	Ordering Number	Dimension, mm	
		L	F
1/4	RBMN-4	19.6	15.9
1/2	RBMN-8	22.6	23.8
3/4	RBMN-12	25.1	33.3
1	RBMN-16	25.9	41.3